

Smart 120 BT Pellet boiler cooker



Nominal heat input	25,2 kW
Nominal heat output	22,7 kW
Nominal heat output to water	17,5 kW
Nominal heat output to air fot radiation	5,2 kW
Efficiency	90,1 %
Exthaus connection	Up/Back
Pipe diameter	100 mm
Dimension H x W x D	87,5x120x60 cm
Weight	330 Kg



FIRE VIEW



HYDRAULIC KIT



DOMESTIC HOT WATER



3-WAY VALVE CONTROL



BOILER CONTROL

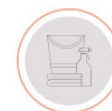

EASY TO CLEAN



WEEKLY PROGRAMMER



DHW PRIORITY



ROOM THERMOSTAT



REMOTE CONTROL



OVEN



COOKING HOTPLATE

Overall dimensions / Connections data sheet (Model with upper flue gas outlet)

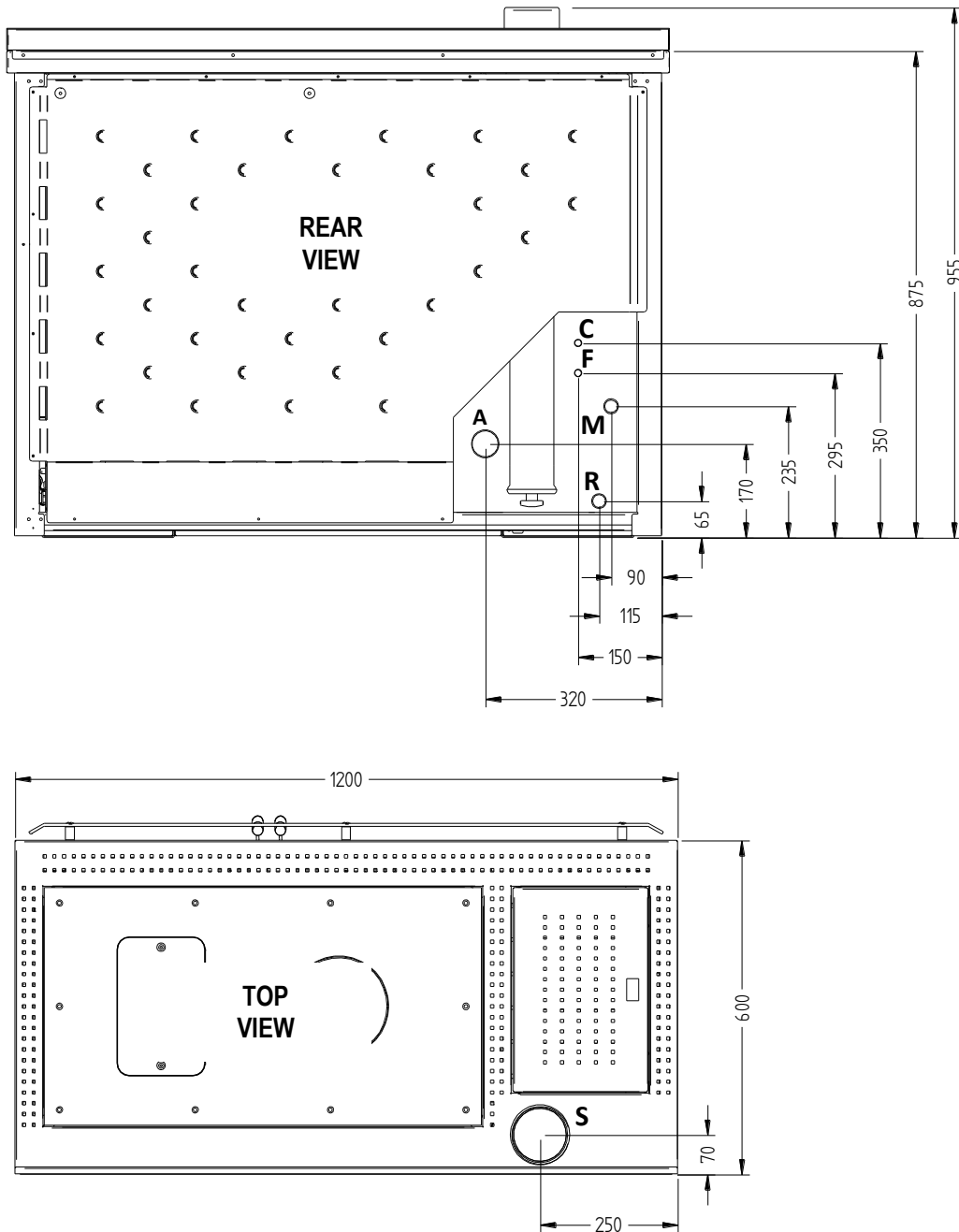

Description of connections

M = System Delivery	3/4" F
R = System Return	3/4" M
F = Domestic cold water inlet (on prepared models only) + system load and boiler body	14 mm
C = Domestic hot water outlet (on prepared models only)	14 mm
A = Intake pipe	50 mm
S = Flue gas outlet	100 mm M

Overall dimensions / Connections data sheet (Model with rear flue gas outlet)

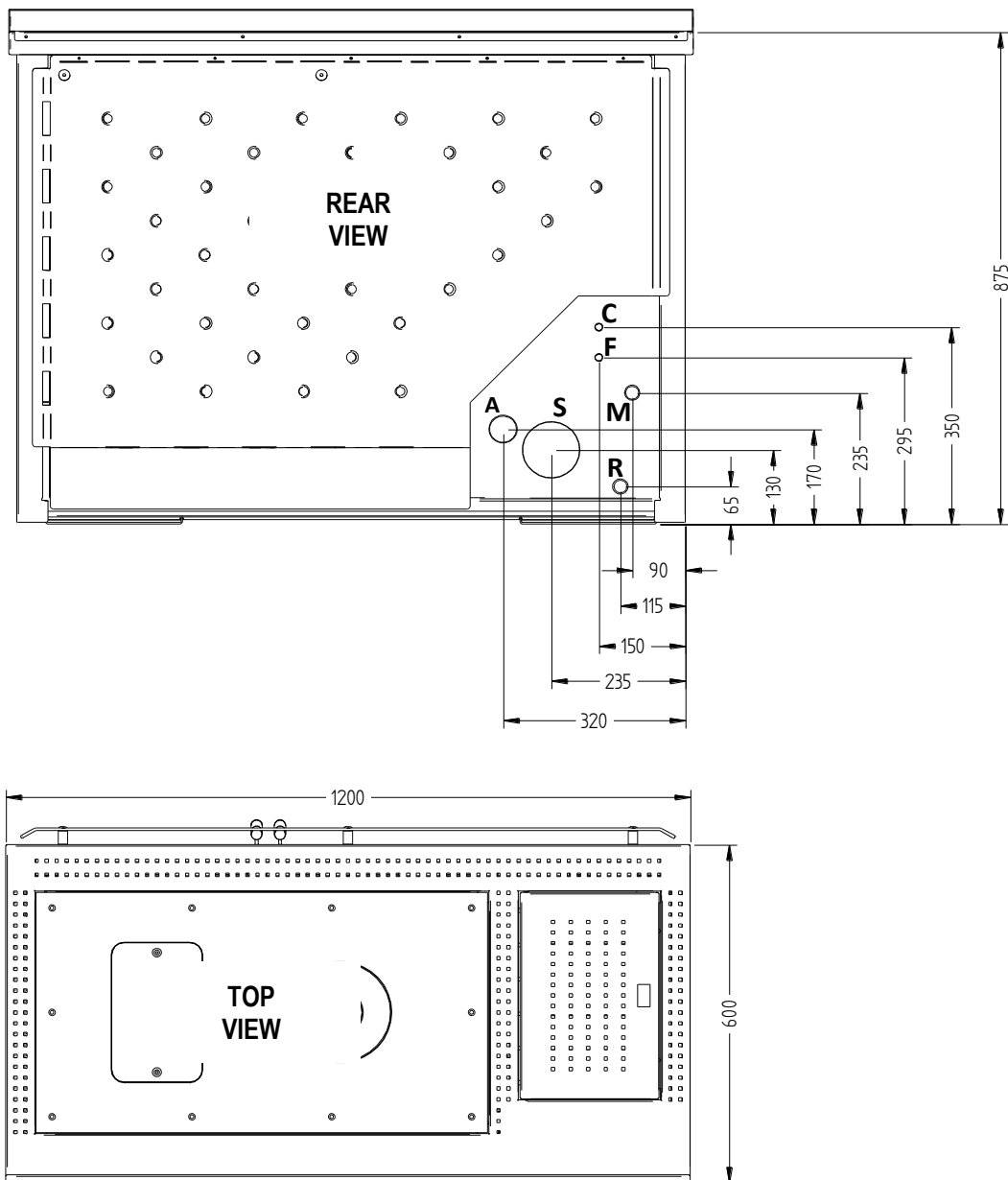

Description of connections

M = System Delivery	3/4" F
R = System Return	3/4" M
F = Domestic cold water inlet (on prepared models only) + system load and boiler body	14 mm
C = Domestic hot water outlet (on prepared models only)	14 mm
A = Intake pipe	50 mm
S = Flue gas outlet	100 mm M