



Nominal heat input	25,2 kW
Nominal heat output	22,7 kW
Nominal heat output to water	17,5 kW
Nominal heat output to air fot radiation	5,2 kW
Efficiency	90,1 %
Exthaus connection	Up/Back
Pipe diameter	100 mm
Dimension H x W x D	87,5x120x60 cm
Weight	330 Kg



FIRE VIEW



HYDRAULIC KIT



DOMESTIC HOT WATER



3-WAY VALVE CONTROL



BOILER CONTROL



EASY TO CLEAN



WEEKLY PROGRAMMER



DHW PRIORITY



ROOM THERMOSTAT



REMOTE CONTROL



OVEN



COOKING HOTPLATE

Overall dimensions / Connections data sheet (Model with upper flue gas outlet)

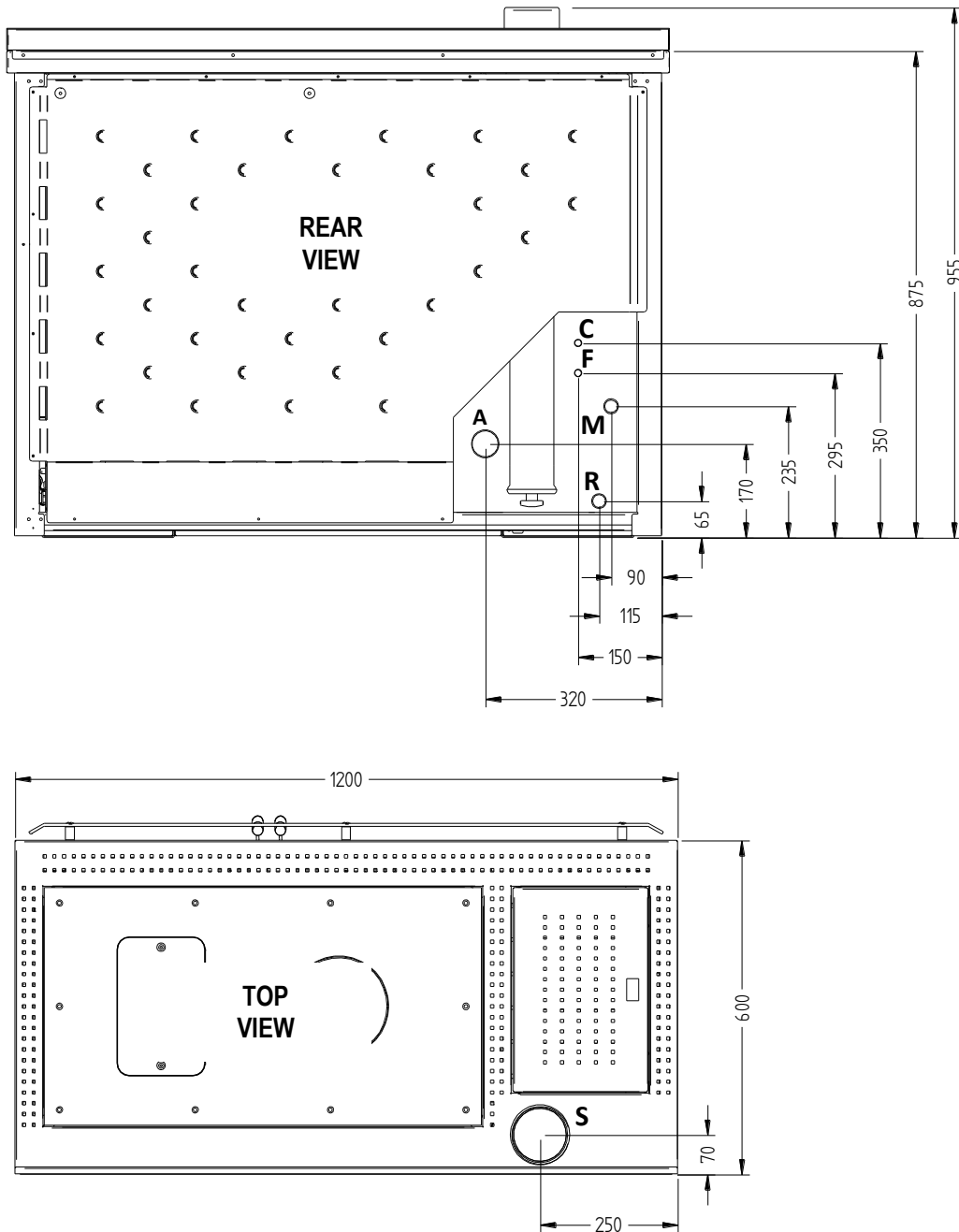

Description of connections

M = System Delivery	3/4" F
R = System Return	3/4" M
F = Domestic cold water inlet (on prepared models only) + system load and boiler body	14 mm
C = Domestic hot water outlet (on prepared models only)	14 mm
A = Intake pipe	50 mm
S = Flue gas outlet	100 mm M

Overall dimensions / Connections data sheet (Model with rear flue gas outlet)

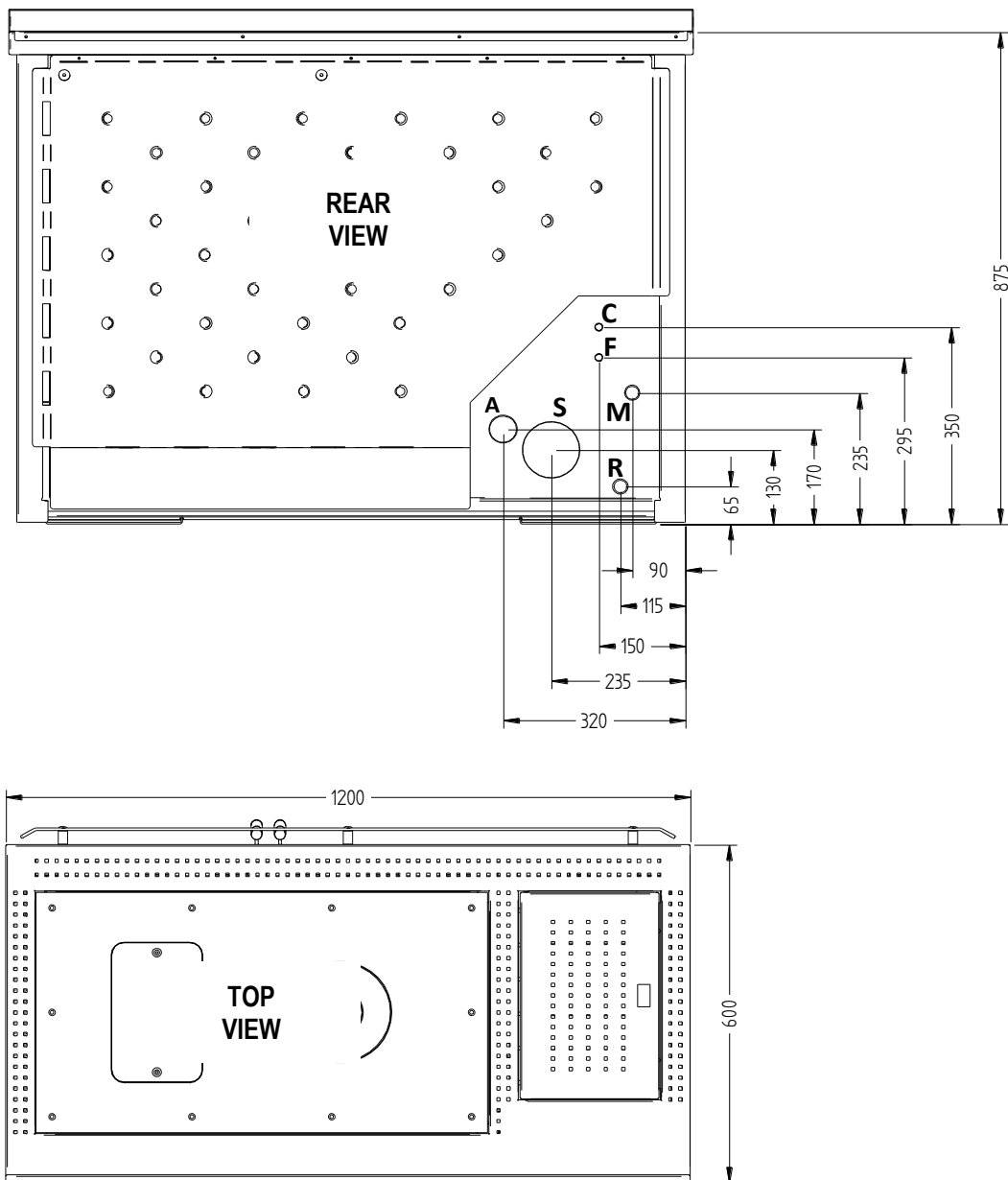

Description of connections

M = System Delivery	3/4" F
R = System Return	3/4" M
F = Domestic cold water inlet (on prepared models only) + system load and boiler body	14 mm
C = Domestic hot water outlet (on prepared models only)	14 mm
A = Intake pipe	50 mm
S = Flue gas outlet	100 mm M