

THE A.B.S. Flexilo MAXI

Pellet storage up to 50 m³

With Flexilo MAXI, the storage of an entire silo truck with reserves is possible. The silos are made of high-strength special fabric, tried and tested over many years in industrial use.

Storage cascade comprising Flexilo Maxi (30 t) for 100 kW pellet heating system in a grammar school



HIGHLIGHTS

- Maximum use of space, i.e. large storage capacity with small space requirements
- Steel frame is delivered in individual parts, therefore it can also be assembled in very inaccessible locations
- Discharge and outlet can be adapted to almost every boiler

Our team is happy to advise you with the planning of your silo system.

TECHNICAL INFORMATION

Bulk weight wood pellets: 0.65 t/m³

The volume indications are calculated values. Filling volumes depend on filler and installation situation (e.g. installation of filling pipes).

Ground clearance and silo outlet diameter are adapted to the extraction unit.

Installation example Flexilo MAXI

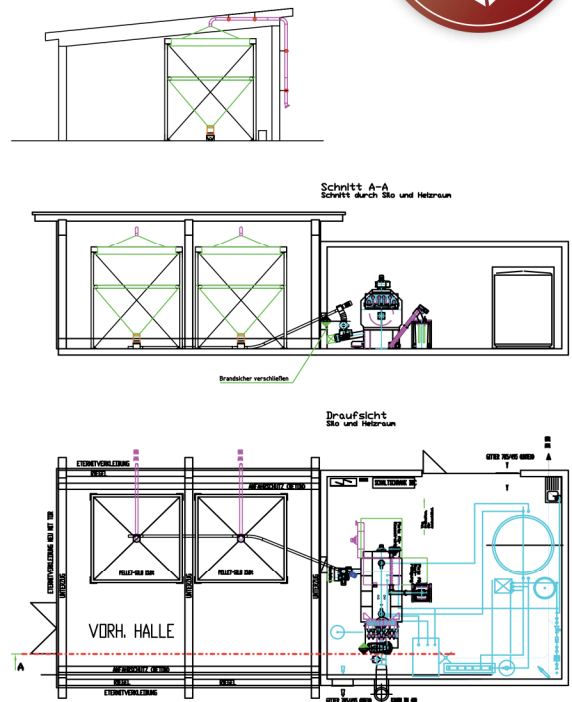

SCOPE OF DELIVERY:

- Silo bag
- Steel frame including cone holding frame, base grounded and assembly material
- Filling system centred above the silo. Delivered with Storz A as standard. In case you require a different coupling, the price must be adapted
- Assembly instructions



IMPORTANT

In the planning stage, please observe information provided in the chapter "Requirements for the installation site", page 3
Please observe the current Firing Ordinance applicable in your country



Weighing technology

On the left side: 2 Flexilo MAXI (30 t) with direct feed of a 480 kW boiler

On the right side: Our own boiler (70kW) with Flexilo MAXI in our company – visitation is possible, after we have arranged an appointment

SIZE CHART Flexilo MAXI

Frame dimensions 3.800 x 3.800 mm

Type of silo	Volume [m ³]	Tonnage [t]	Frame height [mm]	Required room height [m]
HPM36/61G	50.0	32.5	6.60	7.40
HPM36/57G	45.0	29.3	6.20	7.00
HPM36/47G	37.7	24.5	5.20	6.00
HPM36/41G	30.0	19.5	4.60	5.50
HPM36/36G	24.5	15.9	4.10	5.00

Frame dimensions 3.600 x 3.600 mm

Type of silo	Volume [m ³]	Tonnage [t]	Frame height [mm]	Required room height [m]
HPM34/58G	42.0	27.3	6.30	7.00
HPM34/47G	34.0	22.1	5.20	6.00
HPM34/38G	25.0	16.3	4.30	5.20
HPM34/36G	22.9	14.9	4.10	5.00

Frame dimensions 3.200 x 3.200 mm

Type of silo	Volume [m ³]	Tonnage [t]	Frame height [mm]	Required room height [m]
HPM30/58G	37.7	24.5	6.30	7.00
HPM30/55G	35.0	22.8	6.00	6.70
HPM30/47G	28.5	18.5	5.20	6.00
HPM30/43G	25.0	16.3	4.80	5.60
HPM30/37G	20.0	13.0	4.20	5.00
HPM30/31G	15.0	9.8	3.60	4.40

Frame dimensions 2.500 x 2.500 mm

Type of silo	Volume [m ³]	Tonnage [t]	Frame height [mm]	Required room height [m]
HPM24/59G	27.0	17.6	6.40	7.00
HPM24/56G	25.0	16.3	6.10	6.70
HPM24/49G	21.5	14.0	5.40	6.00
HPM24/46G	20.0	13.0	5.10	5.70
HPM24/38G	15.8	10.3	4.30	5.00
HPM24/28G	10.0	6.5	3.30	4.00

Prices on request

Delivery: 3 - 5 weeks after receipt of order and clarification of all commercial and technical details



You will find our discharging accessories for the Flexilo MAXI on page 14